

Information

<Conference Venue>

[Miraikan](#) (National Museum of Emerging Science and Innovation)

2-3-6 Aomi, Koto-ku, Tokyo, 135-0064 Japan

Access to Miraikan

<http://www.miraikan.jst.go.jp/en/guide/route/>

<Registration Desk Opening Hours>

[Welcome Party]

9th Nov. (Tue) 16:00-19:00 Miraikan 7F (in front of Room E)

[Sessions]

10th Nov. (Wed) 9:00-18:00 Miraikan 7F (in front of Room A)

11th Nov. (Thu) 9:00-18:00 Miraikan 7F (in front of Room A)

12th Nov. (Fri) 9:00-15:00 Miraikan 7F (in front of Room A)

[Banquet]

11th Nov. (Thu) 18:00-20:00 [GRANDE PACIFIC LE DAIBA](#) 29F
(in front of Banquet Room 'Ginga')

If you have the registration confirmation e-mail, please show the hard copy to the staff at the registration desk. If not, please use your name to find your registration number and tell the staff.

<Events>

[Welcome Party]

9th Nov. (Tue) 18:00-20:00 Room E (Miraikan 7F)

[Opening and Plenary]

10th Nov. (Wed) 10:00-12:00 Room A (Miraikan 7F)

[Banquet]

11th Nov. (Thu) 18:30-20:30 [GRANDE PACIFIC LE DAIBA](#) 29F
Banquet Room 'Ginga'

[Closing]

12th Nov. (Fri) 15:10-16:10 Room A (Miraikan 7F)

[Farewell Party]

12th Nov. (Fri) 16:10-16:50 Room E (Miraikan 7F)

<Lunch>

Registration fees include lunches for three days.

Lunches are provided as buffet style at the restaurant 'LA TERRE' on the 7th floor of Miraikan from 12:00 until 13:30.

<Drink Services>

Drinks are available during the session breaks.

10 th Nov. (Wed)	14:50-15:10	Foyer (Miraikan 7F)
	16:30-16:50	Foyer (Miraikan 7F)
11 th Nov. (Thu)	10:20-10:40	Foyer (Miraikan 7F)
	14:30-14:50	Foyer (Miraikan 7F)

****Smoking, drinking (beverages) and eating (foods) are strictly prohibited in the Rooms A and B.***

<Conference Language>

The conference language is English. For keynotes plenary sessions, simultaneous translation service is available.

<Instructions for presenters: oral presentations>

- The duration of an oral presentation slot is **20 minutes**. You will have 15 minutes for the presentation itself and 5 minutes for questions from the audience.
- A projector is available in every session room for oral presentations. Presenters are advised to **bring their own laptop PCs**. In case you want to use a local laptop PC available in the session rooms, please bring a full copy of your presentation in Microsoft PowerPoint 97-2003 compatible format on a USB key to the conference.
- Presenters should arrive in their session room before your session start to report to the session chair. Projector switching unit is prepared in session rooms. Presenters are also asked to plug your laptop PCs to switching unit before your previous presentation.
- **During the sessions, please refrain from taking picture with flash or shutter sound.**

<Instructions for presenters: poster presentations>

- Poster sessions are held on **Thu, 11th Nov.**
- Presentation numbers have been assigned to poster presentations. Please check your presentation number from the final program that is available at: <http://www.sntt.or.jp/EcoBalance2010/page/program.html>
- Poster sessions are consisted of two core times:
 - Poster session A: Thu, 11th Nov. 13:30 – 14:30
 - Poster session B: Thu, 11th Nov. 16:50 – 17:50Please check your assigned core time from the final program that is available at: <http://www.sntt.or.jp/EcoBalance2010/page/program.html>
- **Poster presenters are required to make your presentation in front of your poster board during the assigned core time.**
- The dimensions of the posters should be 841 mm x 1189 mm (width x height), equivalent to **A0 size**.
- Poster presenters are kindly requested to attach your poster(s) on the predetermined poster board which will be numbered according to your presentation number **between 8:30 and 13:00** of the poster session day (**Thu, 11th Nov.**).

*Main Entrance opens at 10:00. Please enter from the Service Entrance indicated as below if you arrive at conference venue before 10:00.

1F Floor Map

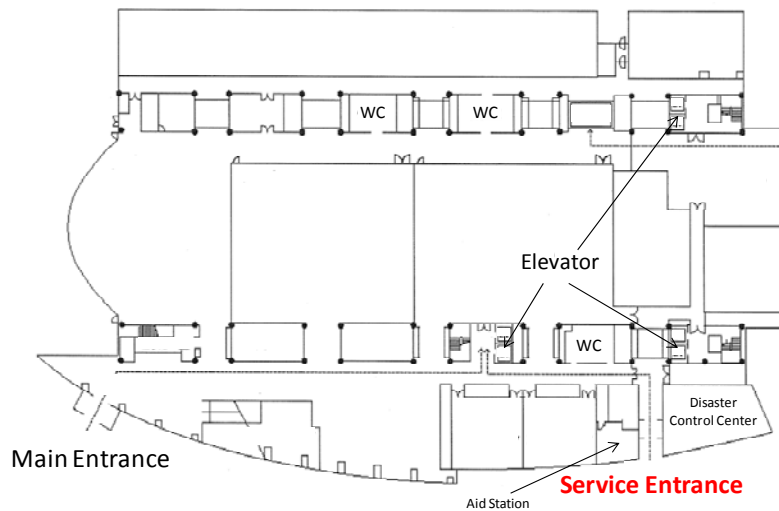

National Museum of Emerging Science and Innovation

 **Miraikan 1F**

CONFERENCE SECRETARIAT:
The EcoBalance 2010
The Society of Non-Traditional Technology
Shinbashi Amano Bldg.6F, 1-5-10
Nishi-shinbashi, Minato-ku, Tokyo, 105-0003 JAPAN
Tel +81-3-3503-4681
Fax +81-3-3597-0535
E-mail EcoBalance2010@sntt.or.jp